

No part of this document may be reproduced in any way or in any form, in whole or in part, or in a natural or machine-readable language, or transmitted on electronic, mechanical, optical, or other media, without the express permission of the Apex Tool Group.

Disclaimer

The Apex Tool Group reserves the right to modify, supplement, or improve this document or the product without prior notice.

Trademark

Cleco is a registered trademark of Apex Brands, Inc.

Manufacturer:

Apex Tool Group, LLC
No.100, Alley 2638 Hong Mei South Road,
Min Hang District, Shanghai, China

Apex Tool Group

670 Industrial Drive
Lexington, SC 29072

Importer:

Apex Tool Group GmbH
Industriestraße 1
73463 Westhausen, Germany

Warning:

- 1) This torque wrench is a product designed for torquing threaded fasteners. Do not use it for any other purpose.
- 2) Do not loosen fasteners with the torque wrench, this may cause damage to the torque wrench or injury.
- 3) Keep the handle clean and free of oil and dirt. Otherwise, it may slip and cause the injury.
- 4) Check the wrench for any cracks, scratches or rust. Above defects may cause damage to the torque wrench and may result personal injury. Perform a functional test and repair if necessary.
- 5) If using overhead wrench drop protection shall be provided. The accidental drop of wrench could cause a serious injury.
- 6) Do not lengthen the handle with a tube. The wrench may be damaged, causing an accuracy error.



Warranty:

- 1) For damage due to the material or process defects or accuracy beyond forward +/-3% according to a qualified torque test device within 12 months after the date of purchase by user (subject to the invoice date), Cleco will provide the repair and calibration or replace the parts for free.
- 2) Damage or accuracy beyond forward +/-3% caused by mis-operation, abnormal use or external damage is not covered under warranty.
- 3) Products repaired or calibrated by third parties other than the CLECO officially authorized service organizations are not covered under warranty.

Operation

- 1) Apply force only in the direction of the arrow as shown on the handle [Figure 2]
- 2) Hold the handle at the force line on the surface. Otherwise, the measurement accuracy may be affected. [Figure 1]
- 3) Stop tightening immediately if a click sound is given; otherwise the actual torque value will be greater than the set value.
- 4) Application direction Force shall be applied perpendicularly to the axis of torque wrench and the center axis of bolt; the force shall be applied smoothly to make the torque wrench rotate constantly. [Figure 2]
- 5) Set the torque value per the instructions below
- 6) Use only good quality sockets that match the square drive of the wrench and fit the fastener being torque. Use of incorrect or worn sockets can result in damage or injury.
- 7) It is recommended that the preset torque wrench is used only by trained or experienced operators. Abnormal use may cause damage to the product , the assembly or injury.

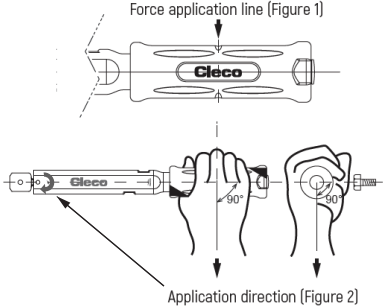

Torque Setting:

- 1) Remove the plug at the end of torque wrench and insert the torque adjustment tool into the hole. [Figure 3]
Note: Torque adjustment tool is not a standard accessory and shall be purchased separately.
- 2) Using a torque analyzer with an appropriate joint simulator, operate the wrench in accordance with the Operation instructions above.
- 3) Adjust the torque to the desired setting and retest. Torque value increases when the adjustment tool is rotated clockwise, and decrease when it is rotated counterclockwise.
- 4) After setting the torque, repeat the operation several times to validate. Once confirmed Insert the plug into the handle.
- 5) It is recommended to verify the torque on a torque analyzer before use.

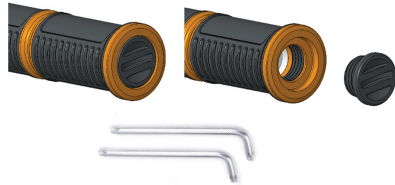

Validation and calibration:

- 1) It is recommended to verify the torque on a torque analyzer before use.
- 2) It is recommended that calibration is performed at a maximum of 100000 cycles or at least once a year.
- 3) If the wrench is stored for an extended period of time perform a calibration before use.
- 4) If the wrench is dropped or damaged inspect, repair if necessary and perform calibration before using again.

Storage:

- 1) Dust, dirt, oil and water on the torque wrench shall be removed after use or before storage. The storage of contaminated wrench may result in the poor operation and abnormal accuracy.
- 2) If storing for an extended period of time , the torque wrench should be set to the minimum torque, coated with the anti-rust oil and stored in a dry place. Improper storage may lead to a rapid decline of accuracy and seriously affect the service life.

POWER TOOLS SALES & SERVICE CENTERS

Please note that all locations may not service all products. Contact the nearest Cleco Sales & Service Center for the appropriate facility to handle your service requirements.

NORTH AMERICA | SOUTH AMERICA

Detroit, Michigan

Apex Tool Group
2630 Superior Court
Auburn Hills, MI 48236
Phone: +1 (248) 393-5644
Fax: +1 (248) 391-6295

Lexington, South Carolina

Apex Tool Group
670 Industrial Drive Lexington, SC
29072
Phone: +1 (800) 845-5629
Phone: +1 (919) 387-0099
Fax: +1 (803) 358-7681

Mexico

Apex Tool Group
Vialidad El Pueblito #103 Parque
Industrial Querétaro Querétaro, QRO
76220 Mexico
Phone: +52 (442) 211 3800
Fax: +52 (800) 685 5560

Brazil

Apex Tool Group
Av. Liberdade, 4055 Zona Industrial
Iporanga Sorocaba, São Paulo CEP#
18087-170
Brazil
Phone: +55 15 3238 3870
Fax: +55 15 3238 3938

EUROPE | MIDDLE EAST | AFRICA

England

Apex Tool Group GmbH C/O Spline
Gauges Piccadilly, Tamworth
Staffordshire B78 2ER
United Kingdom
Phone: +44 1827 8727 71
Fax: +44 1827 8741 28

France

Apex Tool Group SAS
25 Avenue Maurice Chevalier - ZI
77330 Ozoir-la-Ferrière
France
Phone: +33 1 64 43 22 00
Fax: +33 1 64 43 17 17

Germany

Apex Tool Group GmbH
Industriestraße 1
73463 Westhausen
Germany
Phone: +49 (0) 73 63 81 0
Fax: +49 (0) 73 63 81 222

Hungary

Apex Tool Group
Hungária Kft.
Platánfa u. 2
9027 Győr
Hungary
Phone: +36 96 66 1383
Fax: +36 96 66 1135

ASIA PACIFIC

Australia

Apex Tool Group
519 Nurigong Street, Albury
NSW 2640
Australia
Phone: +61 2 6058 0300

Japan

Apex Tool Group Japan
Korin-Kaikan 5F,
3-6-23 Shibakoen, Minato-Ku,
Tokyo 105-0011, JAPAN Phone:
+81-3-6450-1840
Fax: +81-3-6450-1841

China

Apex Power Tool Trading
(Shanghai) Co., Ltd.
2nd Floor, Area C
177 Bi Bo Road
Pu Dong New Area, Shanghai
China 201203 P.R.C.
Phone: +86 21 60880320
Fax: +86 21 60880298

Korea

Apex Tool Group Korea
#1503, Hibrand Living Bldg., 215
Yangjae-dong,
Seocho-gu, Seoul 137-924,
Korea
Phone: +82-2-2155-0250
Fax: +82-2-2155-0252

India

Apex Power Tool India
Private Limited
Gala No. 1, Plot No. 5
S. No. 234, 235 & 245 Indialand Global
Industrial Park
Taluka-Mulsi, Phase I Hinjawadi, Pune
411057 Maharashtra, India Phone: +91
020 66761111

Cleco

PTW05IC, PTW25IC, PTW50IC, PTW100IC, PTW200IC

PRESET TORQUE WRENCH OPERATING INSTRUCTION

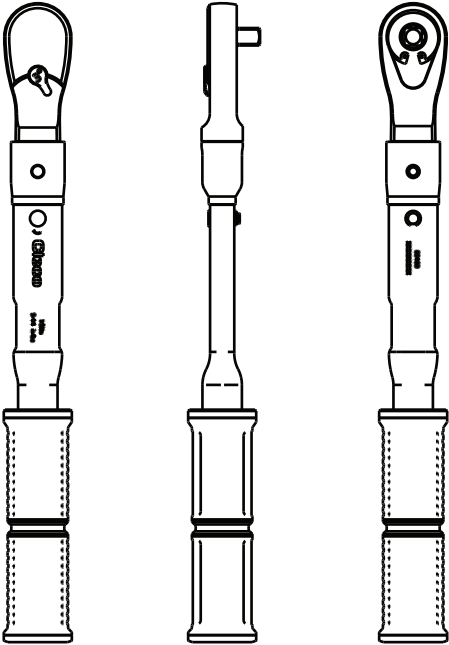

Model Number	PTW05IC	PTW25IC	PTW50IC	PTW100IC	PTW200IC
Torque Range	1-5 Nm	5-25 Nm	10-50 Nm	20-100 Nm	40-200 Nm
	9-44 in.-lbs	44-221 in.-lbs	7-37 ft.-lbs	15-74 ft.-lbs	30-148 ft.-lbs
Head Size	1/4	3/8	3/8	1/2	1/2
Tooth Ct	120	120	120	120	120
Interchangeable	Y	Y	Y	Y	Y
Interchange Size (mm)	9 x 12	9 x 12	9 x 12	9 x 12	14 x 18
Length without Head (mm)	177	231	231	310	422.5
Full Length with Ratchet Head(mm)	233	305	305	400	512
Head Width(mm)	24.5	32	32	44	44
Head Height(mm)	22	27	27	38	38
Weight with Ratchet Head (kg)	0.26	0.64	0.64	1.25	1.5
Torque Accuracy	±4%	±4%	±4%	±4%	±4%
Recommended Calibration interval [50% load]	100K	100K	100K	100K	100K